

### FLOOR MOUNTED LAUNDRY TUB

#### P1 Floor Mounted Poly Tub®

- Supported by steel painted angle legs that slip into molded sockets for rigid friction fit.
- Legs are supplied with leveling devices.
- 4" (102mm) or 8" (203mm) knockout center set faucet holes which are field drilled.
- Includes integral drain and drain plug
- Heavy duty polypropylene material
- Made in the USA

#### Nominal Dimensions:

Overall Outside Dimensions:

24" x 20" x 36-3/16" (610 x 508 x 914.4mm)

Inside Compartment dimensions

19" x 18" x 13-7/8" (483 x 457 x 330mm)

#### Shipping Weight:

13lbs. (5.9 Kg)



### PA11 Floor Mounted Poly Tub TO GO

- Supported by steel painted angle leg that slip into molded sockets for rigid friction fit.
- Legs are supplied with leveling devices.
- Includes A1 chrome plated faucet with 4" (102 mm) centerset, 4" (102 mm) blade handles, 6-3/4" (171 mm) swing spout, aerator and hose adaptor.
- Includes laundry tub with legs, faucet, integral drain with plug, p-trap and supply line.
- 4" (102mm) or 8" (203mm) knockout center set faucet holes which are field drilled.
- Heavy duty polypropylene material
- Made in the USA

#### Nominal Dimensions:

Overall Outside Dimensions:

24" x 20" x 36-3/16" (610 x 508 x 914mm)

Inside Compartment dimensions

19" x 18" x 13-7/8" (483 x 457 x 330mm)

#### Shipping Weight:

15lbs. (6.8 Kg)

SEE REVERSE FOR ROUGHING-IN DIMENSIONS

#### Optional Components for P1:

- ☐ **A1** Deck type faucet - 4" (102mm) center set with 6-3/4" (171mm) spout
- ☐ **A2** Overflow pipe with "O" ring to fit 1-1/2" strainer.
- ☐ **A17** Faucet for top supplies. Clamps on with swing spout and angled nose end.

All products are cUPC listed



**MODEL P1 FLOOR  
MOUNTED POLY TUB®**

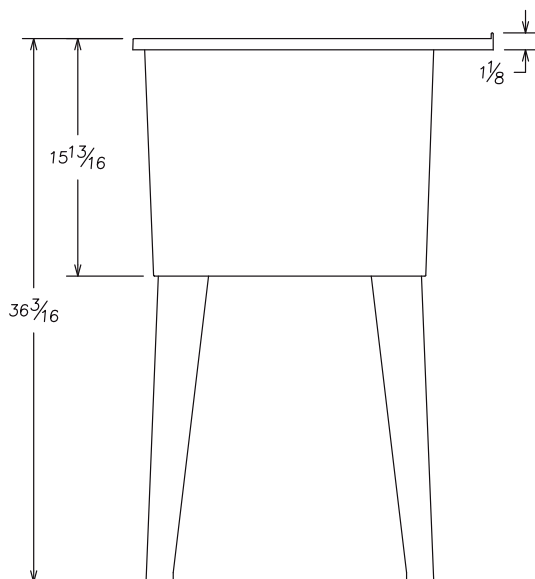
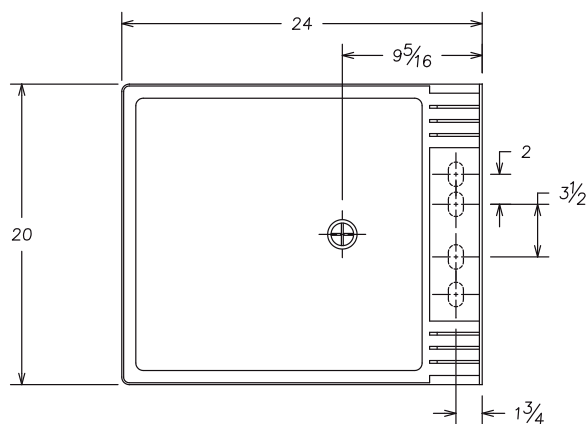

**IMPORTANT:** Roughing-in dimensions may vary  $\frac{1}{8}$ " and are subject to change or cancellation without prior notice.