

INSTALLATION INSTRUCTIONS

Pooch & Boots Scrub Tub

Model PW-2424 & PW-3624

FIAT
PRODUCTS

Thank you for selecting Fiat Products. To ensure this product is installed properly, please read these instructions carefully before you begin. *(Certain installations may require professional help.)* Visit our website for information on the warranty and care and cleaning.

IMPORTANT: Unpack your new Pooch and Boots Scrub Tub and inspect carefully for damage. Exercise care during installation. Rough handling or dropped tools may chip or crack material.

OBSERVE LOCAL PLUMBING AND BUILDING CODES

INSTALLATION PLANNING

Locate area of installation, prepare a 5-3/4" diameter opening for drain water. Area for installation should be at least 24" x 24" or 36" x 24" depending on size of basin. On the site where the FIAT Pooch and Boots Scrub Tub is to be installed, the wall and floors should be clean, dry and free of dirt. If your scrub tub will be installed in a corner or wall, this determines how many back panels will be used (See Figures 5 & 6).

THE PW-2424 KIT INCLUDES:



MSB2424

One (1) 24" x 24"
Molded Stone Basin



MSG2424

Two (2) 24" x 12"
Wall Guards and one (1) L-Bracket
Twelve (12) 1" Phillips Screws

THE PW-3624 KIT INCLUDES:



MSB3624

One (1) 36" x 24"
Molded Stone Basin



MSG3624

One (1) 36" x 12" and One (1) 24" x 12"
Wall Guard and one (1) L-Bracket
Twelve (12) 1" Phillips Screws

THE PW-2424 & PW-3624 KITS INCLUDE:



C-108DCC

One (1) PRIER C-108 Hot & Cold Wall
Hydrant and two (2) Phillips Screws



One (1) Garden Hose Sprayer
with Soap Dispenser



One (1) 5' Stainless Steel Hose



QDC3XH

Rubber Gasket



One (1) Hose Hook
and two (2) 1.5" Phillips
Flat Head Screws



Lint Basket
Strainer



One (1) Leash Hook with
four (4) 2" Phillips Flat Head
Screws & Carabiner



1453BB

One (1) Stainless
Steel Strainer

1

MSB2424/ MSB3624 INSTALLATION INSTRUCTIONS

1. Refer to "Rough-In dimensions (See Figure 1) and determine location of Mop Basin.
2. Prepare a 5-3/4" diameter opening with top of the 3" PVC drain pipe centered 1/2" below the finished floor surface (See Figure 2).
3. Set the basin in place and align the drain body with the drain pipe. Level basin and shim as necessary. (See next page for step 4).

MSB2424

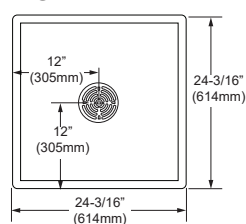

MSB3624

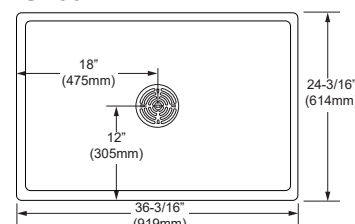

Figure 1

1

MSB2424/ MSB3624 INSTALLATION INSTRUCTIONS

4. Connect the drain line to the basin with included QDC3XH rubber gasket or lead caulk joint (See Figure 3).
5. Once the basin is in place, apply silicone sealant (not included) at all points where mop basin meets the wall (See Figure 4).
6. Place lint basket into drain and finish by locking the strainer into place by twisting.

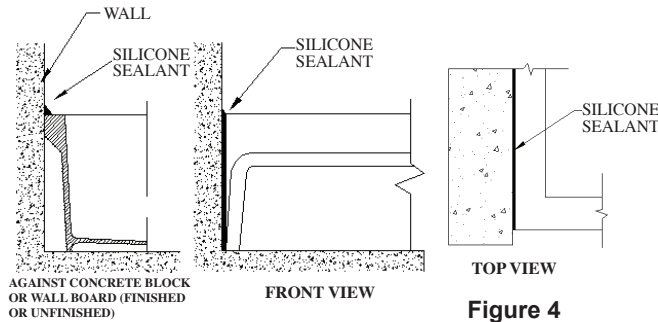

Figure 4

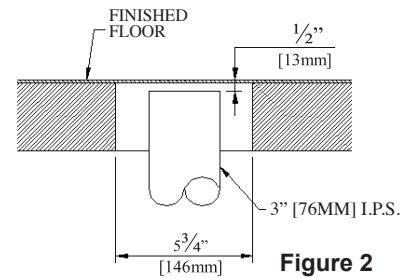

Figure 2

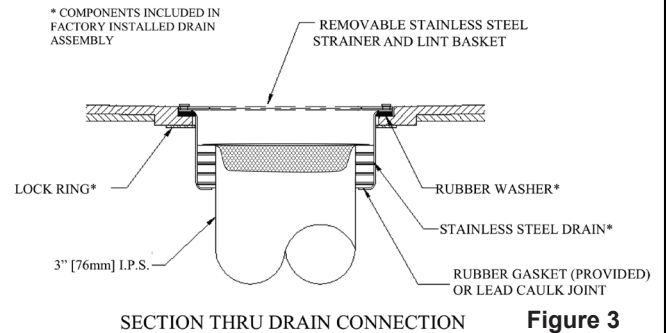

Figure 3

2

MSG2424 OR MSG3624 INSTALLATION INSTRUCTIONS

1. Place L-Bracket in corner and line up a wall guard with screw holes. Place wall guard flush with top and side of mop sink.
- Only use L-Bracket for corner installations (See Figure 5 vs 6).
2. Drill in the provided screws into the pilot holes.
3. If installing in a corner, repeat step one and two with adjacent wall guard.
4. Caulk between guard and mop basin.



Figure 5

3

PRIER C-108 INSTALLATION INSTRUCTIONS

1. Determine the location for the installation of the hydrant. Ensure there is adequate work room in the interior of the structure for securing the hydrant to the plumbing piping.
2. The PRIER C-108 is designed to be installed horizontally with the outlet left, right or vertically with the outlet at the bottom. If horizontal, be careful that it is not angled such that the outlet is above the centerline. **Valve will not drain properly if the spout outlet is above the supply piping.**
3. Using the template on the C-108 box, level on wall and bore two (2) 1 inch holes at 3 1/2 inch centers through the wall in the desired position for the installation.
4. All wall hydrants require a slight downward pitch to aid the draining process of the hydrant once the product is turned to the "off" position and the hose disconnected.
5. Secure the hydrant to the structure using appropriate screws (not included) through the two mounting holes on the casted back flange. If hydrant is installed into drywall, use screw anchors for stability.
6. Ensure supply piping is free of debris, solder and sealants.
7. If you are planning to solder the connection, be certain the hydrant is in the fully open position to prevent seat damage from the heat.
8. Connect the water supply piping to the wall hydrant as desired. With a closed-end hose on the valve creating back pressure, test the installation for leakage.

4

ACCESSORIES INSTALLATION INSTRUCTIONS

1. After the PRIER C-108 is installed, install hose hook (see Figure 6) with the four (4) provided screws into a stud.
2. Attach the leash hook (see Figure 6) with four (4) provided screws into a stud.
3. Use carabiner for easy attachment to leash hook
4. Attach hose to sprayer and C-108.
5. Add soap (not included) and turn dial to desired setting. Turn dial back to water to stop soap.



Figure 6