

**FL-1 FLOOR MOUNTED SERV-A-SINK®**  
**L-1 WALL HUNG SERV-A-SINK®**

Fiat Products uses a specialized SMC process (Molded Stone®) to manufacture all laundry tubs. Moldings are manufactured in matched metal dies under heat and pressure resulting in a one-piece homogeneous molded unit. Drain(s) with stopper(s) are furnished as standard equipment. Water capacity is twenty (20) gallons. Laundry sinks available in white only.

- All products must be installed in accordance with installation instructions provided. Failure to do so may invalidate warranty at manufacturer's discretion.

**FL-1 Floor Mounted Serv-A-Sink®**

- Supported by steel painted angle legs that slip into molded sockets for rigid, friction-fit. (Included)
- Easy leveling devices are provided for fast, even planning.

**Nominal Dimensions:**

Overall Outside Dimensions:

23" x 21-1/2" x 33-1/2" (584 x 546 x 838mm)

Inside Compartment dimensions

22-1/4" x 17" x 12" (565 x 432 x 305mm)

**L-1 Wall Hung Serv-A-Sink®**

- Supported by one mounting brackets of heavy gauge galvanized steel capable of being secured to the wall with mechanical fasteners. (Included).
- Side fillers which are assembled in field to the mounting brackets, are made of white molded plastic polymer.

**Nominal Dimensions:**

Overall Outside Dimensions:

23" x 21-1/2" x 13-7/16" (584 x 546 x 330mm)

Inside Compartment dimensions

22-1/4" x 17" x 12" (565 x 432 x 305mm)

**All products are cUPC listed**  
**CSA Approved**



**FL-1 Floor Mounted Serv-A-Sink®**

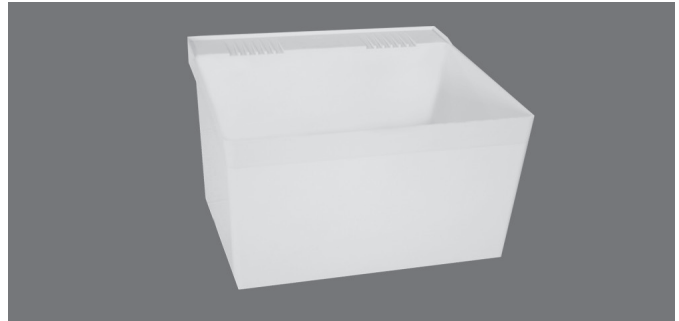

**L-1 Wall Hung Serv-A-Sink®**

SEE REVERSE FOR ROUGHING-IN DIMENSIONS

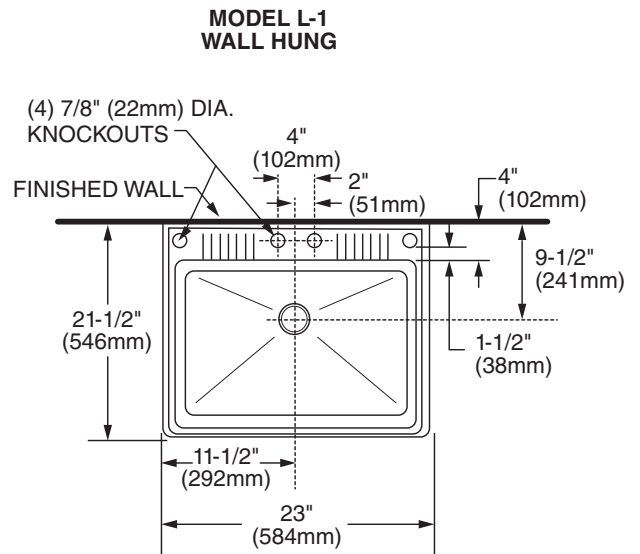
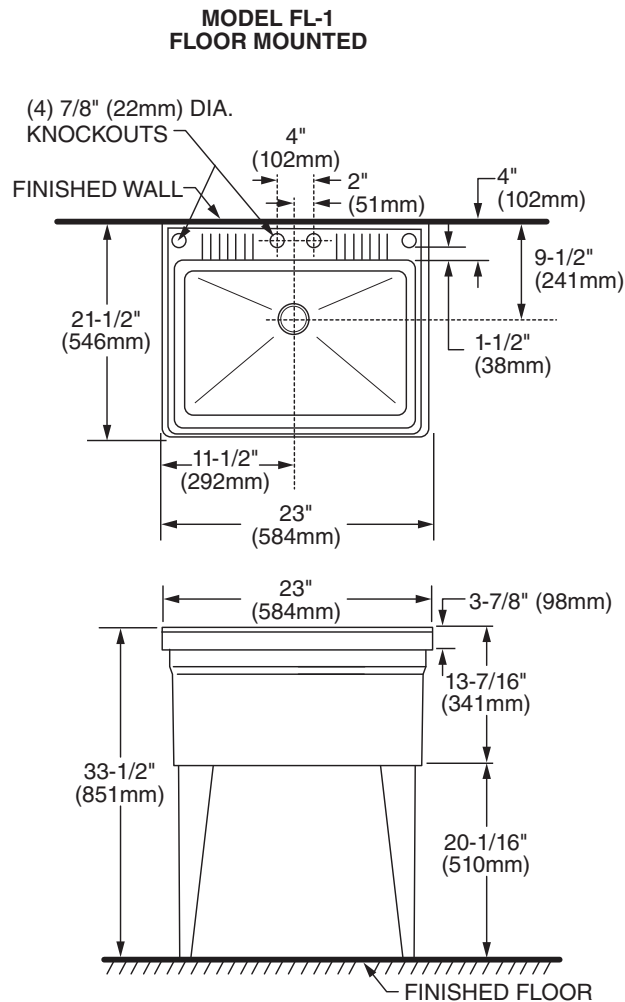

**IMPORTANT:** Roughing-in dimensions may vary 1/2" and are subject to change or cancellation without prior notice.