

# INSTALLATION INSTRUCTIONS

## Stainless Steel Shelf

Model: 889CCSHELF

**FIAT**  
PRODUCTS

Thank you for selecting Fiat Products. To ensure this product is installed properly, please read these instructions carefully before you begin. *(Certain installations may require professional help.)* Visit our website for information on the warranty, care and cleaning.

**IMPORTANT:** Unpack model 889CCSHELF and inspect carefully for damage. Exercise care during installation. Rough handling or dropped tools may chip, dent or crack material.

### FOLLOW LOCAL PLUMBING AND BUILDING CODES

#### PREPARATION

- Refer to "Rough-In" dimensions and determine where the FIAT 889CCSHELF will be installed.
- Mark the hole locations using recommended measurements shown in Figures 1 & 2.

#### INSTALLATION INSTRUCTIONS

1. Hold the shelf level and flush with the wall using the marked hole locations as guides.
2. Use the provided mounting hardware to securely attach the shelf to the wall.

**Note:** Make use of the 16" center hole locations to secure into a stud for maximum strength. To ensure proper stability, use all holes (4 total) on each vertical support to attach into stud.

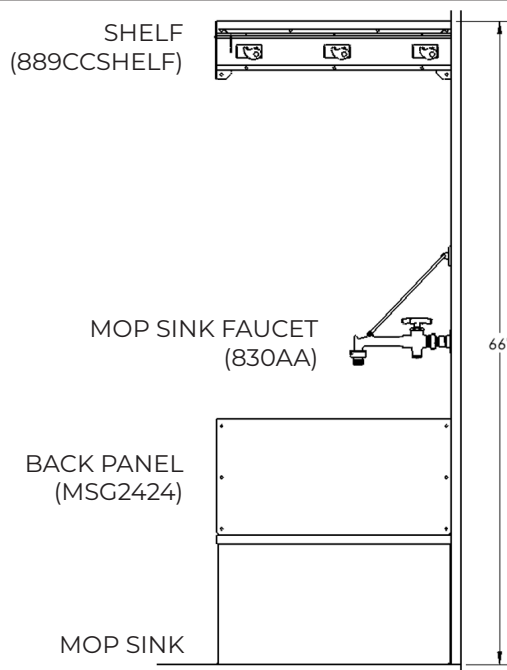

**Figure 1**

#### DIMENSIONS

- Recommended to mount top of shelf 5-1/2 feet (66 inches) above the finished floor to ensure ease of access when using mop hangers.

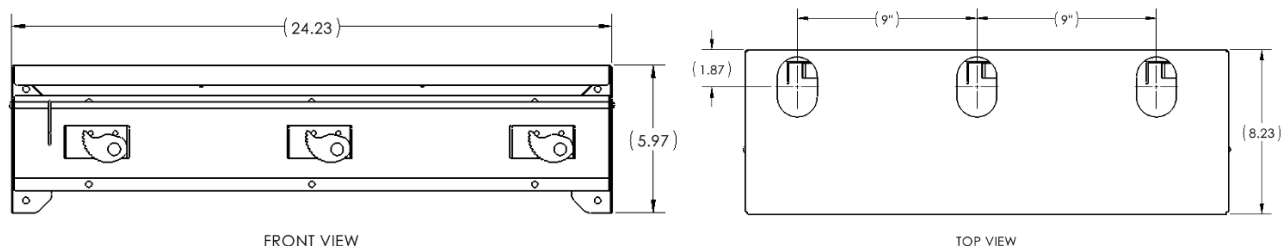

**Figure 2**